



**STRONG PARTNERS.  
TOUGH TRUCKS."**



# **HYSTER**

## **LITHIUM-ION POWERED PALLET TRUCK**

**PC1.5 / 1500 KG**

**[HYSTER.COM.AU](http://HYSTER.COM.AU)**



## > OVERVIEW

# PC1.5

**THE HYSTER® LITHIUM-ION POWERED PALLET TRUCK PC1.5 OFFERS IMPROVED EFFICIENCY, REDUCED STRAIN ON OPERATORS AND AN EXCELLENT COST OF OWNERSHIP. COMPACT AND LIGHTWEIGHT, WITH MINIMAL MAINTENANCE REQUIREMENTS, SIMILAR TO A HAND PALLET TRUCK. THE PC1.5 CAN WORK AT THREE TIMES THE INTENSITY AND WITH A 6-SECOND BATTERY EXCHANGE TIME, IS IDEAL FOR CONTINUOUS OPERATIONS.**

### Productivity ————— Cost of Ownership Delivered ————— Reliable

- Compact and lightweight design
- Powered travelling, lifting and lowering
- Efficiency is tripled over a hand pallet truck
- 6-second battery exchange; suitable for continuous operations
- Intelligent Remote Control key option (Standard for Australia)
- Re-charge alert
- Optional large battery with 3-hour fast charger
- Emergency reverse "belly" button
- Ergonomic, multi-function handle with LCD display to maximise uptime
- Easy and simple to maintain
- Maintenance free components; brushless drive motor and lithium-ion battery
- 60-second drive wheel replacement
- Durable steel frame and protective cover
- Performs well on gradients

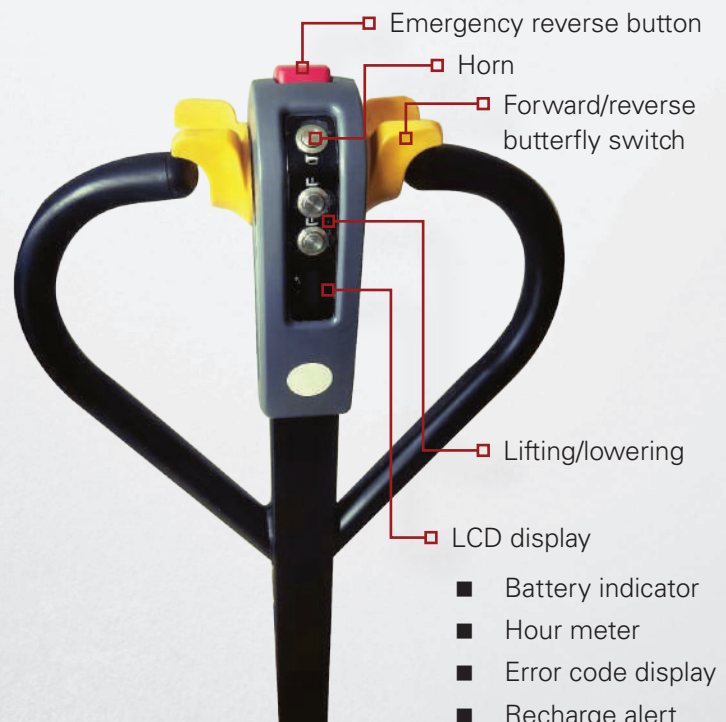

## > POWERED PALLET TRUCK VS. HAND PALLET TRUCK

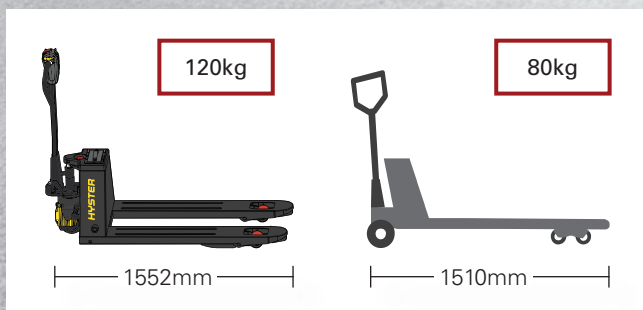

**Compact and Lightweight**



**Single/Dual Tandem Load Wheels**



**Protective Cover**

## > SPECIFICATIONS AND DIMENSIONS

MANUFACTURER	MEASUREMENT	HYSTER	
Model designation		PC1.5	
Operator type		Pedestrian	
Rated capacity	Q (kg)	1500	
Load center	c (mm)	600	
Overall fork width	B1 (mm)	550 / 685	
Fork dimensions	s x e x l (mm)	58 x 160 x 1150	58 x 160 x 1220
Wheelbase	y (mm)	1197	1267
Overall length	L1 (mm)	1552	1622
Turning radius	Wa (mm)	1353	1426
Aisle width for pallets 1000 x 1200 crossways / 800 x 1200 lengthways	AST $\alpha$ / $\beta$ (mm)	1718 / 1687	
Lowered height - top of forks	h (mm)	82	
Total lift	h3 (mm)	115	
Height of tiller (min. / max.)	h14 (mm)	640 / 1250	
Maximum gradeability (laden / unladen)	%	6% / 20%	
Travel speed (laden / unladen)	Km / h	4.0 / 4.5	
Control type		DC	
Drive / lift motor	Kw	0.75 / 0.5	
Lift speed - laden / unladen (lowering speed - laden / unladen)	m / s	0.018 / 0.023 (0.056 x 0.046)	
Travel brake type		Regenerative	
Service brake type		Electromagnetic	
Service weight (inc. battery)	Kg	120	125
Axle loading laden front / rear (unladen front / rear)	Kg	1134 / 486 (88 / 32)	
Drive wheel x(1)		$\varnothing$ 140 x 55 Poly	
Load wheel (single x(2) / dual x(4) )		$\varnothing$ 80 x 93 Poly / $\varnothing$ 80 x 70 Poly	
Battery type		Lithium	
Battery capacity	Ah	10 / 15	
Battery voltage	V	48	
Power Consumption in accordance with VDI cycle	kWh / h	0.42	
Sound level at driver's ear EN12053	dB(A)	69	

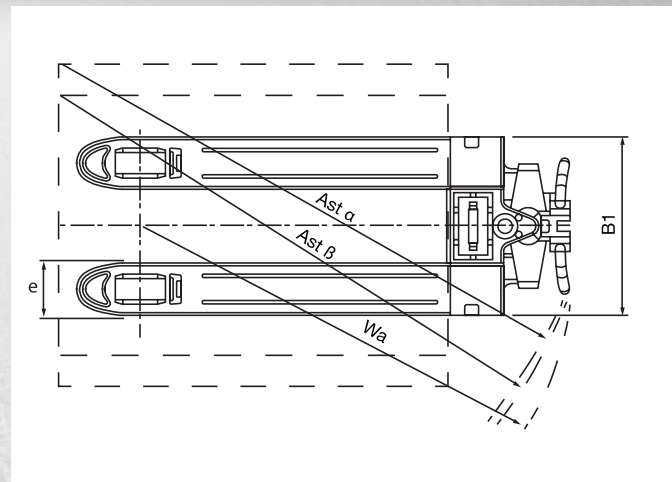
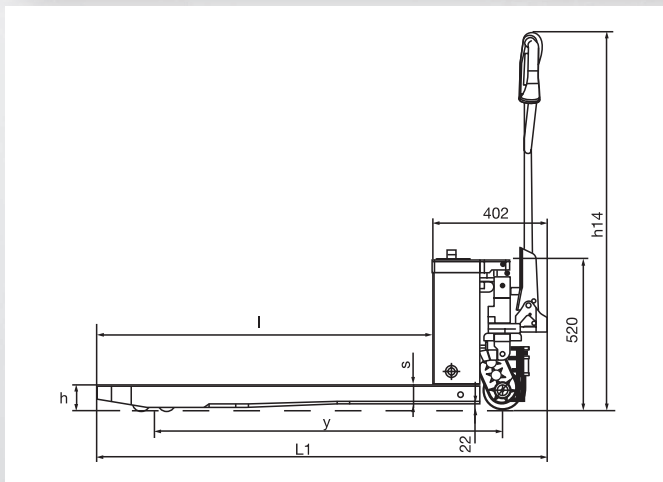

## > OPERATOR ASSIST FEATURES



### Speed Setting

Convenient fast / slow pre-set speeds

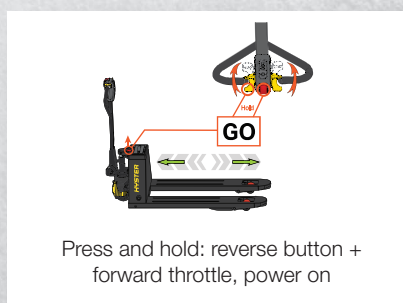

### Up-Right Drive

Maximise efficiency in tight spaces

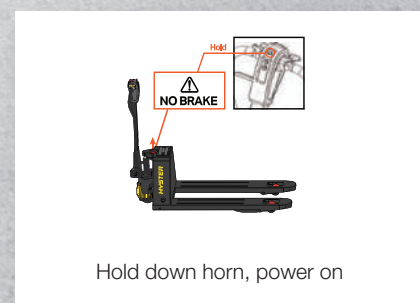

### Service Mode

Utilise brake release in emergencies



# HYSTER® DEALERS



Contact your nearest Hyster® Dealership  
by visiting [www.hyster.com.au](http://www.hyster.com.au)

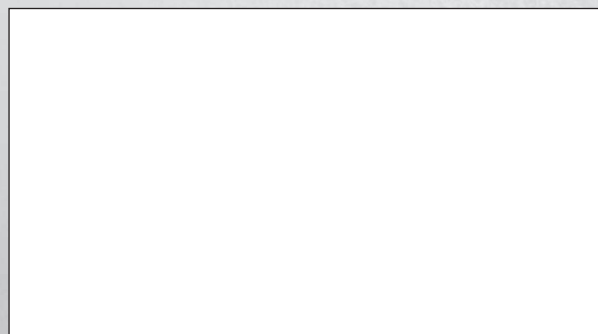

## HYSTER PACIFIC

1 Bullecourt Avenue, Milperra NSW, Australia 2214  
Tel: +61 (2) 9795 3800 Fax: +61 (2) 9792 8484  
[hyster.com/pacific/en-au](http://hyster.com/pacific/en-au)

## HYSTER ASIA

16 Tuas Avenue 20, Singapore 638827  
Tel: +65 6863 3387 Fax: +65 6863 3349  
[hyster.com/asia/en-sg](http://hyster.com/asia/en-sg)



[/Hyterasiapacific](https://www.facebook.com/Hyterasiapacific)



[HysterJAPIC](https://www.linkedin.com/company/HysterJAPIC)



[Hyster Asia-Pacific](https://www.youtube.com/HysterAsia-Pacific)

© Hyster Asia Pacific 2022. All rights reserved. HYSTER,  and Strong Partners. Tough Trucks are trademarks of Hyster-Yale Group, Inc. Specifications and details in this brochure are subject to change without prior notification. Please consult with your Hyster dealer for the most up to date information and to confirm exact capacities.

3025HBC3BC001\_E-EN-SG\_V1R1-06022022\_Lithium-ion Powered Pallet Truck PC1.5 Brochure

**HYSTER.COM.AU**

